

CD WELD STUDS

ISO13918

Other specifications are available upon request

Materials/finishes:

WSSTDC - Steel, Copper Plated

WSA2DC - Stainless Steel

WSALDC - Aluminium

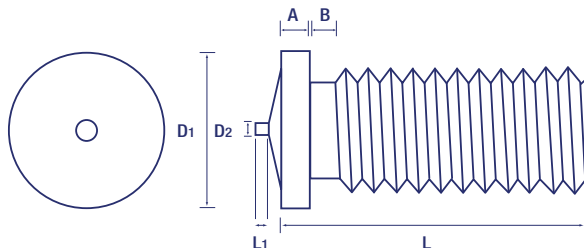

Metric Dimensions

Thread	M3	M4	M5	M6	M8
D1 ±0.2	4.5	5.5	6.5	7.5	9.0
A	0.7 - 1.4	0.7 - 1.4	0.8 - 1.4	0.8 - 1.4	0.8 - 1.4
B	1.5	1.5	2.0	2.0	3.0
D2 ±0.8	0.60	0.65	0.75	0.75	0.75
L1 ±0.5	0.55	0.55	0.80	0.80	0.85

Contact TR:

T: 00 44 8454 811 800 | F: 00 44 870 458 7851 | E: sales@trfastenings.com

www.trfastenings.com

HEX WELD NUTS

DIN929

Other specifications are available upon request

Materials/finishes:

HESTWN - Steel/Self Colour

HEA2WN - A2 Stainless Steel/Self Colour

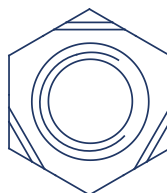

SQUARE WELD NUTS

DIN928

Other specifications are available upon request

Materials/finishes:

WQSTWN - Steel/Self Colour

WQA2WN - A2 Stainless Steel/Self Colour

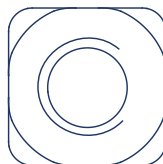

There are many different styles and types of weld nuts in the market place conforming to various international standards. TR is a stockist of many of these, including a comprehensive range of DIN standard nuts. Go to www.trfastenings.com to view dimensional data and for further information.

Contact TR:

T: 00 44 8454 811 800 | **F:** 00 44 870 458 7851 | **E:** sales@trfastenings.com

www.trfastenings.com